

AElement - ANSI

AELEMENT BY SALTO | STYLISH LOCKS

The AElement is an RFID lock that allows you to integrate all your physical security needs into one stylish, energy efficient, reliable, wire-free system.

The minimalistic design of its RFID reader looks chic and discreet on any door, and can be combined with a wide range of either SALTO or designer handles.



AELEMENT - ANSI

AE90 | AELEMENT

The AELEMENT ANSI version is specially designed to fit on most ANSI A 156.13 doors. The minimalistic design of the RFID reader looks stylish and discreet on any door. It also offers the choice of a wide range of designer lever handles and finishes.



ELECTRONICS FEATURES:

- Reader body made using double layered injection construction.
- Clear dual colour LED light (green/red) to indicate lock authorisation.
- Mechanical privacy option by a mechanical thumbturn. The user can activate the “do not disturb” function just by operating this thumbturn.
- Special blink and beep indication when lock is in privacy mode.
- Ability to enable/disable the acoustic signal.
- Available with mechanical cylinder key override or access lock outs (override mortise cylinders).
- Compatible with European ANSI A 125.13. mortise lock retrofit.
- UL10C compliant.
- Declaration of conformity CE.
- FCC/IC conformity.

READER COLOUR:



BASE FRAME FINISHES:

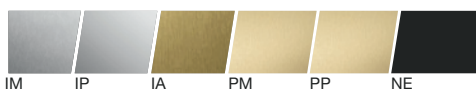

IM IP IA PM PP NE

TECHNICAL CHARACTERISTICS:

- Covers door thicknesses: From 35mm - 45mm up to 115mm - 125mm.
- Reader dimensions: 67mm x 45mm x 17mm.
- Battery pack dimensions (inside): 116mm x 65mm x 25.5mm.
- Handle block mechanism lock.
- Handle rotation: 52°.
- To be used in combination with SALTO LA1T17 mortise lock.
- Square spindles available: 8mm split (SALTO spindles required).

PLATFORMS:



ID TECHNOLOGIES :

- MIFARE® (DESFire EV1, Plus, Ultralight C, Classic - ISO/IEC 14443).
- Bluetooth SMART (BLE).
- NFC.

TECHNICAL DRAWING:

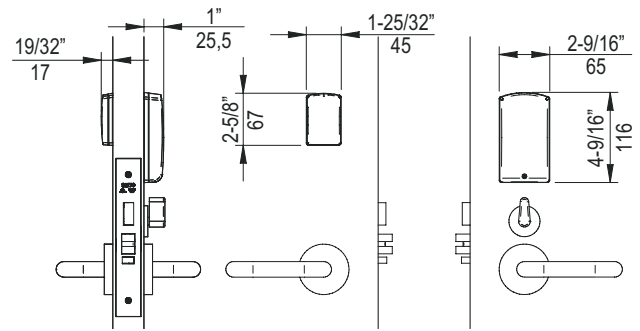

ANSI A 125.13 AELEMENT MORTISE LOCK:

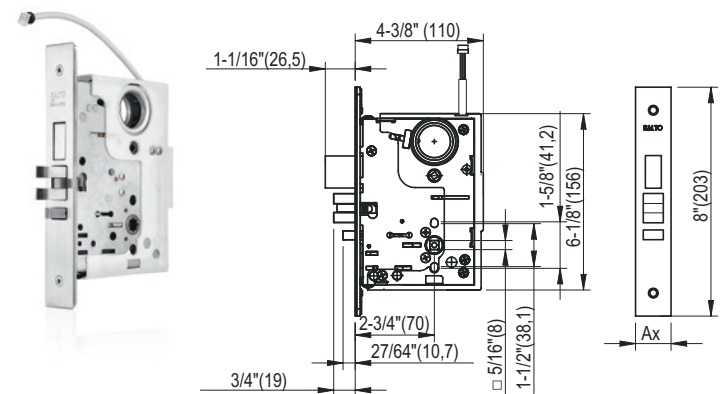

MORTISE LOCKS FEATURES:

- Mortise lock with built in door detector, privacy detector and mechanical key override detector.
- Axe distance 62mm.
- Lock latched deadbolt made of steel.
- Choice of finishes: satin stainless steel or gold enamelled.
- Front plate shape: square.
- Handed lock - L/R - reversible.
- Inside always allows free egress (Anti-panic in combination with lock).
- UL 10C listed (90 min).



Technical Data

POWER SOURCE:

- AElement: 3 alkaline batteries - LR03 - AAA 1,5V.

NUMBER OF OPENINGS:

- Contactless versions: Up to 50,000 openings.
- Low battery power indication monitored through the SALTO Virtual Network (SVN).
- The last approx. 1,000 operations are signalled.

ENVIRONMENTAL CONDITIONS:

- Electronics: 0° / 60°.
- Not suitable for outdoor use.

Main Features

- Easy to maintain: Battery change is all that's needed.
- SALTO SVN and SALTO Wireless network capable.
- Wireless ready lock that can be upgraded to wireless online.
- Handle block mechanism lock.
- To be used only with SALTO AElement mortise lock series.
- Compatible with DIN standard and ANSI mortise locks.
- Reader body made using double layered injection construction.
- Electronic privacy system. By pressing a button on the battery holder on European models, the user can activate the "do not disturb" function.
- The lock can always be opened from the inside (single action panic feature works in conjunction with the SALTO mortise lock).
- Clear dual colour LED light (green/red) to indicate lock authorisation.
- Concealed fixing screws for greater security and improved aesthetics.
- Wire-free stand-alone networked system through SVN technology.
- Attractive range of standard handle designs and finishes, designer lever handles from well-known brands approved.
- DDA (Disability Discrimination Act) compliant (depending on handle type).
- Emergency opening via contactless Portable Programming Device (PPD).

Access Control Features

USERS & DOORS:

- Maximum number of users per door: 4 million.
- Maximum number of doors per system: 65,000.
- Access levels: unlimited.

CALENDARS & TIME ZONES:

- Calendars in system: 256
- Time tables: 1024
- Time periods: 1024

EVENTS:

- Maximum events on lock audit: 2200.
- Non volatile memory (memory is not deleted, even if power fails).

MANAGEMENT SOFTWARE:

- SALTO ProAccess SPACE.

ID TECHNOLOGIES:

- Covering the mainstream MIFARE RFID technologies.
 - Compatible with ISO 14443A, ISO 14443B and ISO 15693 (Vicinity).
-

Lock Modes

STANDARD:

Locked at all times.

AUTOMATIC OPENING:

8 pairs of "hands free" timed lock and unlocks per day with holidays.

TOGGLE:

Present card to lock, present card to unlock.

TIMED TOGGLE:

Present card to lock, present card to unlock depending on schedules

OFFICE MODE:

Free passage mode (just on the ANSI version).

EXIT LEAVES OPEN MODE:

The lock remains unlocked after the inside handle is used.